

NOTICE: THIS DRAWING IS THE PROPERTY OF MCA ARCHITECTURE INC. AND IS FURNISHED WITH THE CONDITION THAT IT IS NOT TO BE CHANGED WITHOUT THE WRITTEN AUTHORIZATION OF MCA ARCHITECTURE INC. FURTHERMORE, THIS DRAWING IS NOT TO BE COPIED, REPRODUCED OR USED WITHOUT WRITTEN PERMISSION FROM MCA ARCHITECTURE INC.  
 © 2022 MCA ARCHITECTURE 3/25/2023 2:49:25 AM



SANDY RUN INDUSTRIAL PARK

ZEUS INDUSTRIAL PRODUCTS, INC.

No.	Description	Date
A	FOR REVIEW	24 MAR 23

<b>MASTERPLAN</b>		Project number:	A19003.0	<b>ASG-100</b>
		Drawn by: PCP	Checked by: KMC	

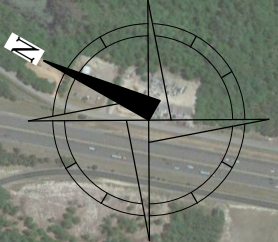

NOTICE: THIS DRAWING IS THE PROPERTY OF MCA ARCHITECTURE INC. AND IS FURNISHED WITH THE CONDITION THAT IT IS NOT TO BE CHANGED WITHOUT THE WRITTEN AUTHORIZATION OF MCA ARCHITECTURE INC. FURTHERMORE, THIS DRAWING IS NOT TO BE COPIED, REPRODUCED OR USED WITHOUT WRITTEN PERMISSION FROM MCA ARCHITECTURE INC.  
 © 2022 MCA ARCHITECTURE 3/25/2023 2:49:44 AM

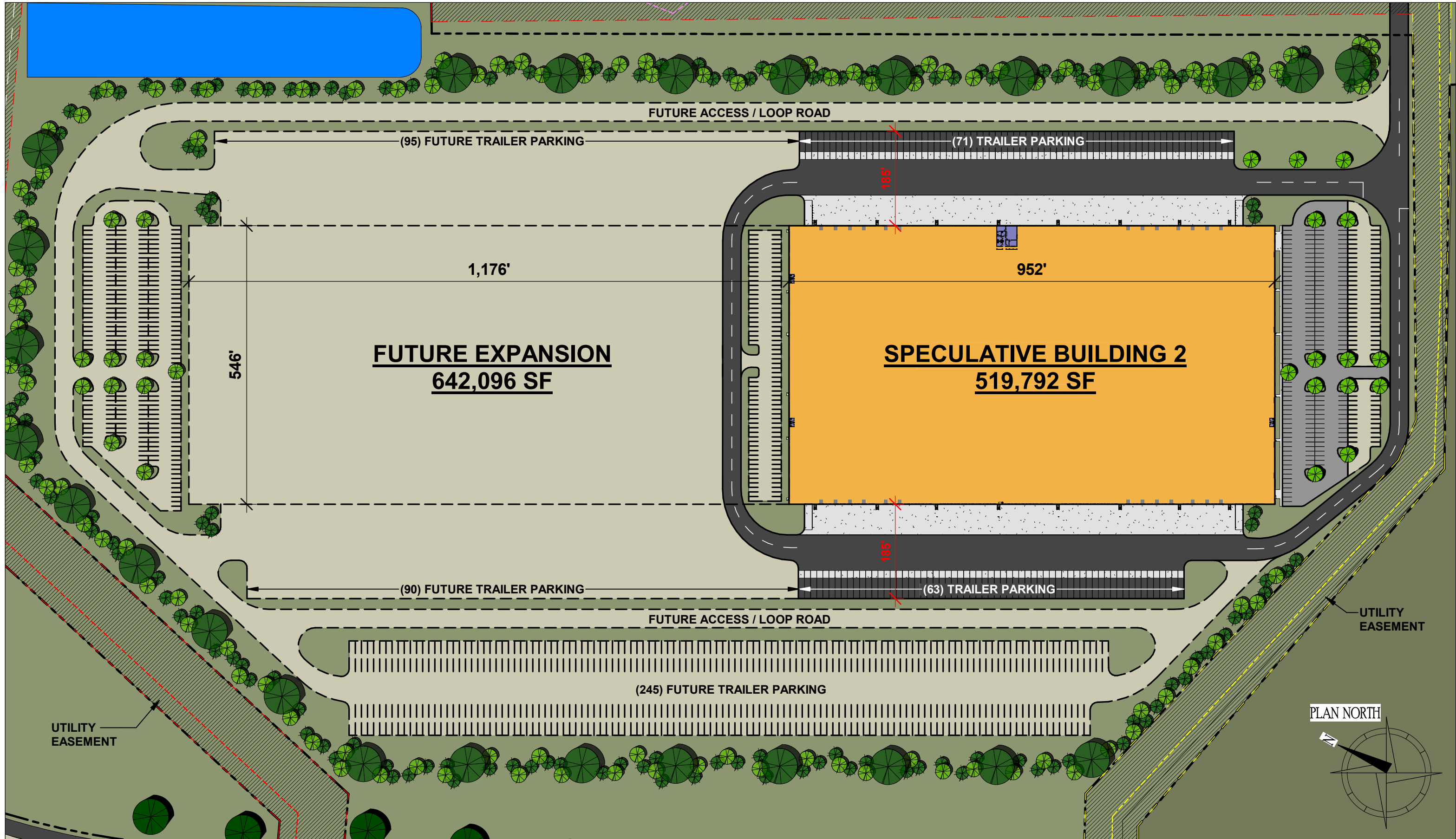

SANDY RUN INDUSTRIAL PARK

No.	Description	Date
A	FOR REVIEW	24 MAR 23

**SPEC BLDG #2 OVERALL SITE PLAN**

Project number: A19003.0  
 Drawn by: ACC Checked by: KMC  
 Scale: 1 : 2100

**ASG-103**

NOTICE: THIS DRAWING IS THE PROPERTY OF MCA ARCHITECTURE INC. AND IS FURNISHED WITH THE CONDITION THAT IT IS NOT TO BE CHANGED WITHOUT THE WRITTEN AUTHORIZATION OF MCA ARCHITECTURE INC. FURTHERMORE, THIS DRAWING IS NOT TO BE COPIED, REPRODUCED OR USED WITHOUT WRITTEN PERMISSION FROM MCA ARCHITECTURE INC.  
 © 2022 MCA ARCHITECTURE 3/25/2023 2:49:50 AM

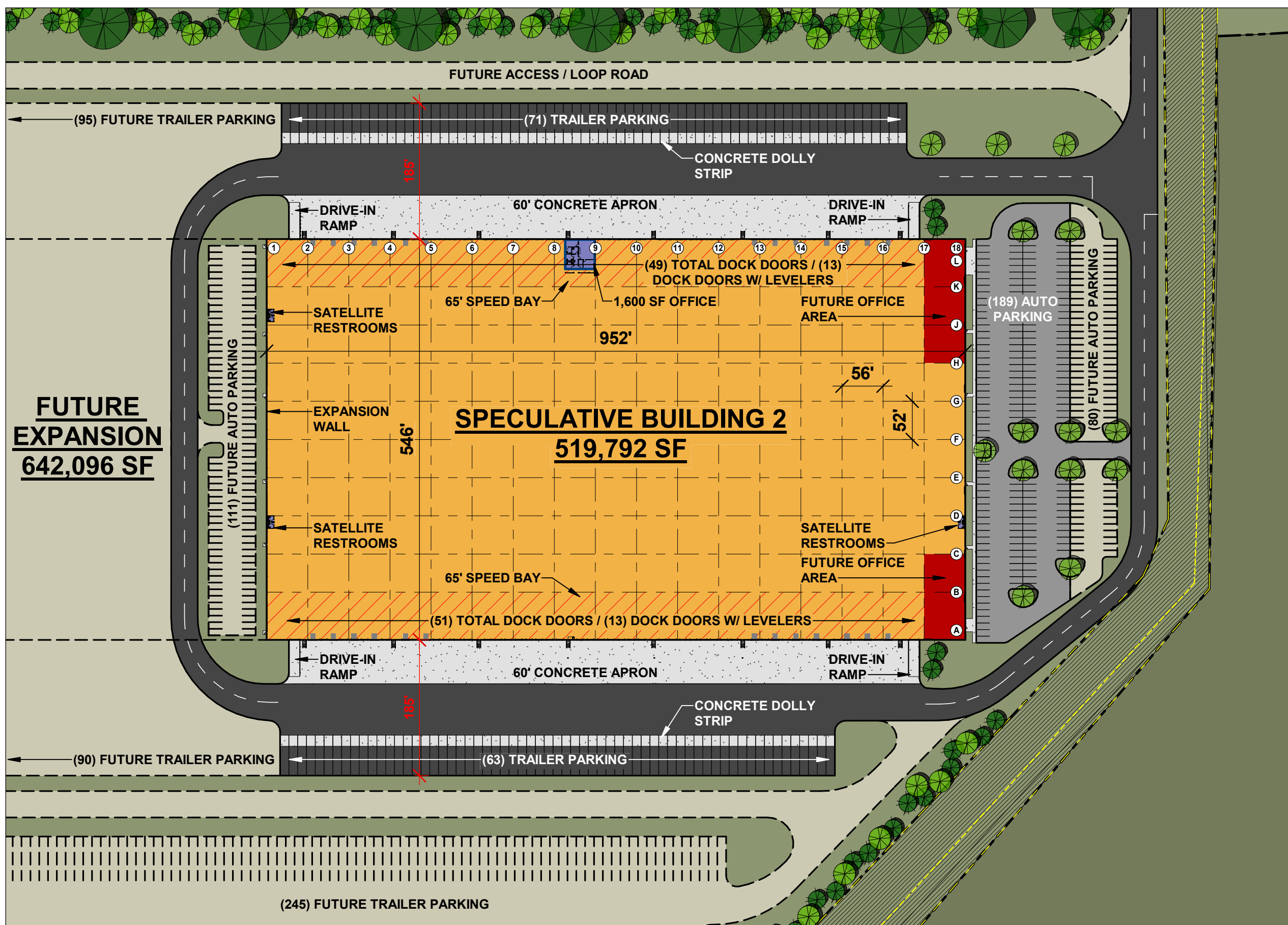

NOTES	
<b>CAR PARKING</b>	
PLAN EAST	189
FUTURE PARKING	191
FUTURE EXPANSION PARKING	269
<b>TOTAL POTENTIAL PARKING</b>	<b>649</b>
<b>TRAILER PARKING</b>	
PLAN NORTH	71
PLAN SOUTH	63
<b>TOTAL</b>	<b>134</b>
<b>FUTURE TRAILER PARKING</b>	
FUTURE PLAN NORTH COURT	95
FUTURE PLAN SOUTH COURT	90
FUTURE EXPANSION LOT	245
<b>TOTAL FUTURE PARKING</b>	<b>430</b>
*TRAILER PARKING SIZED AT 12' WIDE X 60' DEEP	
<b>DOCK DOORS</b>	
PLAN NORTH W/OUT LEVELERS	36
PLAN NORTH W/ LEVELERS	13
PLAN SOUTH W/OUT LEVELERS	38
PLAN SOUTH W/ LEVELERS	13
<b>TOTAL</b>	<b>100</b>

- H.D. ASPHALT
- L.D. ASPHALT
- CONCRETE

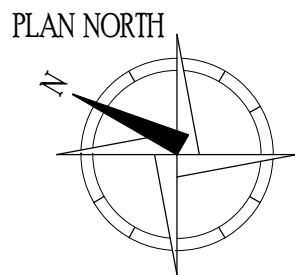

SANDY RUN INDUSTRIAL PARK

No.	Description	Date
A	FOR REVIEW	24 MAR 23

**SPEC BLDG #2 ENLARGED SITE**

Project number: A19003.0

ASG-104

Drawn by: TJW    Checked by: KMC    Scale: As indicated